

Let's Dispose of Trash Properly!

3 Principles of Disposing Trash

- ① The correct type of trash
- ② on the correct day
- ③ in the correct location

Basic Rules

- Dispose of burnable (except branches and leaves) and landfill waste using designated trash bags.
- Anything that does not fit in a designated trash bag is large size waste and must be paid for.
- Dispose of trash by 8:30 AM on the designated collection day.
- Please refer to the trash and recycling calendar regarding trash collection on holidays and during New Year's.



Please buy designated trash bags at stores with this sticker.

Paid

Please use designated trash bags (except for large size waste)

Free

Please use a clear trash bag up to 45L.

Burnable Twice a week



Paid



*For long items that do not fit in the bag such as scrap lumber, tie them together in bundles of up to 1 m in length and 10 cm in diameter and wrap each bundle with a designated bag (excluding extra-small size).

Free



Fallen leaves, pruned branches

Paper Waste Wednesday



Free

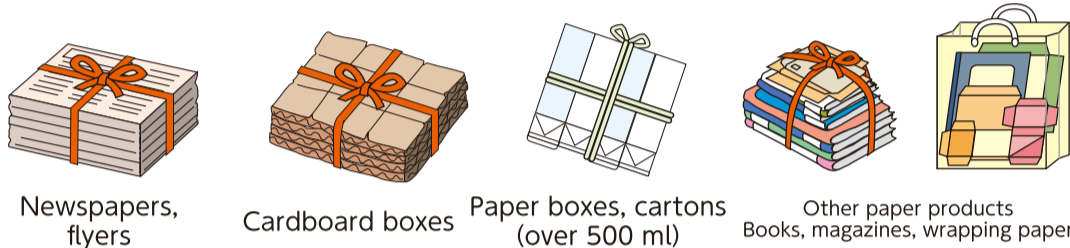

*Please divide the paper up into each type of paper and tie each stack together with string.

*Other types of paper should be tied into bundles or placed in paper bags.

*Paper cups, thermal paper, photographs etc should be disposed of as burnable waste.

Plastic Container & Wrapping Waste Once a week



Free

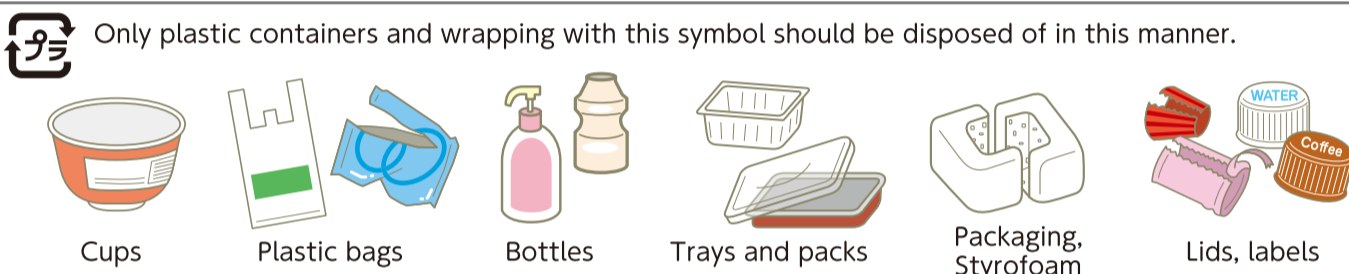

Only plastic containers and wrapping with this symbol should be disposed of in this manner.

*Dirty waste or plastic goods should be disposed of as burnable waste.

*Do not dispose of this trash on windy days.

Recyclable Waste Twice a month



Free



○Mark clearly if a bicycle is trash.

○Please delete the registration on the bike before disposing of it.

○Please throw away underwear, curtains, and blankets containing cotton with burnable garbage.

PET Bottles Twice a month



Free

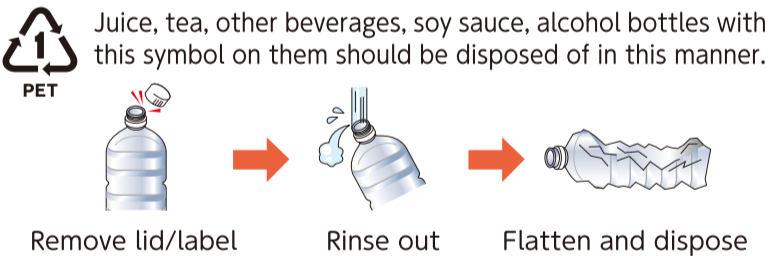

Juice, tea, other beverages, soy sauce, alcohol bottles with this symbol on them should be disposed of in this manner.

Hazardous waste (special waste) Twice a month



Free

They are household items (5 in total) that contain mercury and explosive or flammable fluids such as: 1) fluorescent tubes; 2) mercury thermometers; 3) gas cans or spray cans; 4) lighters; and 5) dry-cell batteries.



Landfill Waste Twice a month



Paid

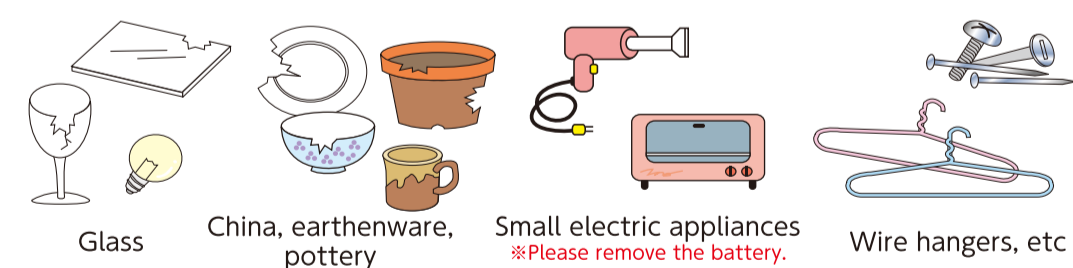

○Please wrap up sharp objects (broken objects, knives) and mark as dangerous (危険).

*For metal rods, and other long items that do not fit in the bag, tie them together in bundles up to 1 m in length and 10 cm in diameter and wrap each bundle with a designated bag.

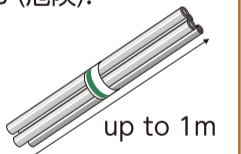

up to 1m

Large Waste Application required



Paid

★Please contact the following before disposing large waste★

Trash Zero TEL.0570-00-5374



*Hours / Monday - Saturday
8:30 AM - 5:00 PM

*Up to 5 items may be disposed at once.

*The cost is either 500 yen or 900 yen based on the size of the item.

Waste the city does NOT collect

No designated disposal areas

Large quantities of garbage e.g. after moving or spring cleaning, tires, fire extinguishers, kerosene, business garbage, TVs, refrigerators, air conditioners, washing machines, personal computers, etc.

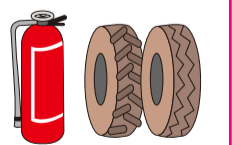

➔ Please consult with an expert or the shop where you purchased the product.



Garbage Sorting App

Kumamoto City just released the "Garbage Sorting App (English/Chinese)", equipped with a variety of functions such as informing you about the garbage collection dates or introducing garbage disposal procedures. Just download the app to your smartphone or tablet by scanning this QR code!



●For consultation regarding garbage Gomi Zero Call / TEL.0570-00-5374

●You can also get advice in foreign languages here The Kumamoto Consultation and Support Plaza for Foreign Residents / TEL 096-359-4995